

PRODUCT TECHNICAL SHEET

Collection : **ANDREW**

Ref. : **4585.11.71**

Thermostatique bain à encastrer, 2 robinets d'arrêt, douchette et bec
Inbouw badthermostaat, 2 afsluitkranen, handdouche en uitloop
Concealed bath thermostatic, valve, 2-way diverter, handshower and spout

Picture

Product details



Flow at 3 bar : 21 l/min
10 l/min (Handshower)

Internal mechanism : Ceramic valve 1/4 turn

T° mechanism : Thermostatic wax cartridge

Technical drawing

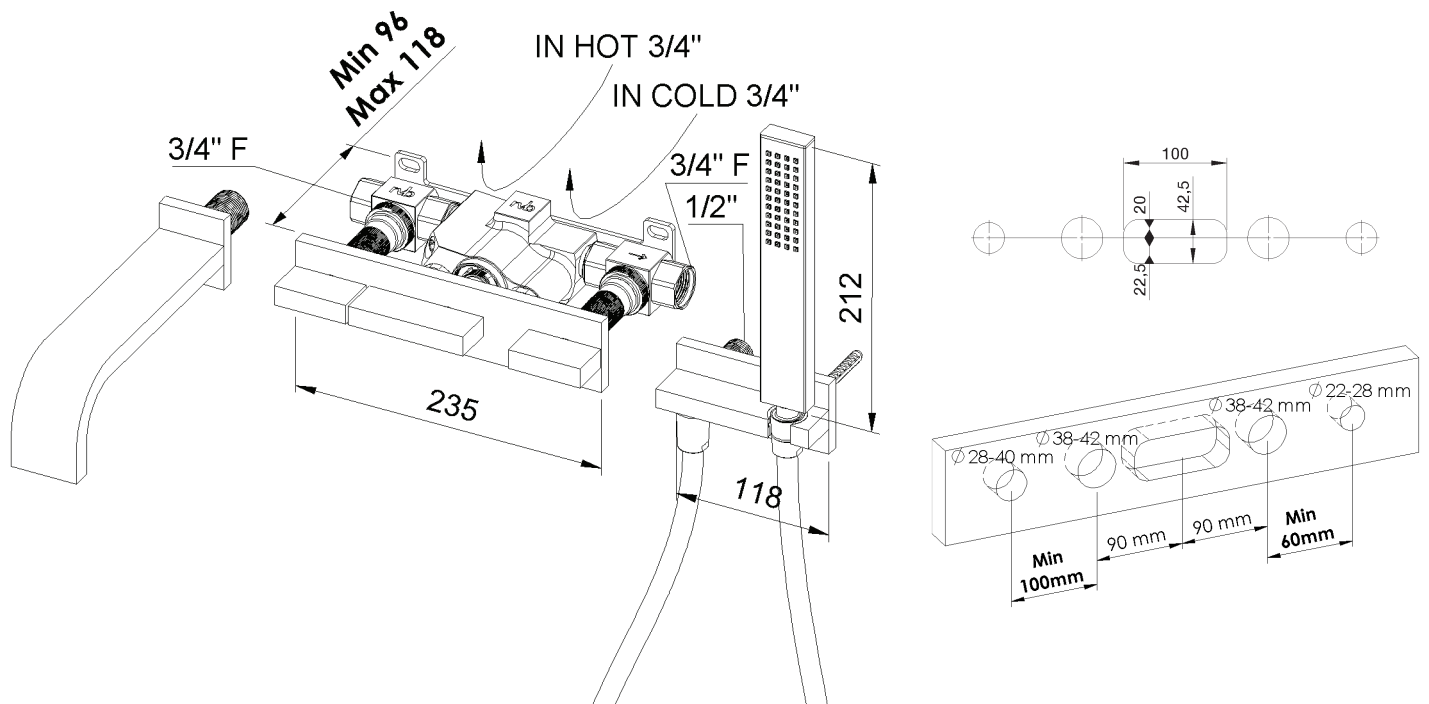

RB0.V01